



# Werrington Primary School



## Newsletter

2<sup>nd</sup> July 2021.



### Staffing for 2021/22

Teaching staff arrangements for 2021/22 are as follows:

Nursery	Mrs. R. Brookes
Reception	Miss. A. Woodward / Miss. M. Carruthers
Reception	Miss. L. Davies
Year 1	Mrs. A. Welford
Year 1	Mrs. L. McGill
Year 2	Mrs. H. Gerrard
Year 2	Miss. S. Millward
Year 3	Mrs. L. Wright
Year 3	Miss. R. Hampson
Year 4	Miss. R. Dimmock
Year 4	Miss. G. Whitmore
Year 5	Miss. H. Turner
Year 5	Mrs. C. Little
Year 6	Mrs. S. Lockett
Year 6	Mr. K. Hubbard

Mrs Bolton will lead SEN and Forest Schools.

**Our end of year reports to parents will be sent home on Monday 5<sup>th</sup> July. The report will include details of your child's new class.**

### 'Move up day'

In preparation for September, children from Nursery through to Year 5 will be able to spend the day with their new teacher, and in their new classrooms, on **Tuesday 6<sup>th</sup> July.**

The children will enter and exit the school by their new doors – ie: Current Year 1 children will use the Year 2 door, current Year 2 children will use the Year 3 doors, etc. See the map overleaf for location of doors. Unfortunately, high Schools are unable to host a transition day for Year 6 pupils at the moment so we have arranged for our current Year 6 pupils to spend the day with 'LMA', participating in PE and in team building activities – They will enter and exit the school via the usual doors and wear PE kit on Tuesday 6<sup>th</sup> July.

### Parents Evening

We do offer parents the opportunity to have an end of year catch up with their child's teacher.

Our planned Parents Evening is scheduled for

Wednesday 7<sup>th</sup> July – This will take the form of a 'virtual' meeting. Appointments can be booked via <https://werrington.schoolcloud.co.uk>

Please note: Year 6 Parents Evening is scheduled for Tuesday 6<sup>th</sup> July

### School Closure

Don't forget, **school closes at 1:30pm** on Wednesday 21<sup>st</sup> July and re-opens at 8:45am on Thursday 2<sup>nd</sup> September.

### School Gates

If you pull into the school gateway to drop your child off in the morning, please stop this – It is extremely selfish and puts our children in danger.

### Could you foster?

Nexus Fostering is a well-established and highly regarded fostering agency, based in Telford, who are urgently seeking full-time & respite foster carers throughout the area. The agency is rated Ofsted 'Outstanding' in all areas and place a high premium on the quality of support and care that they provide to every one of the foster carers and, in turn, the children and young people placed with them. To find out more about becoming a foster carer or a respite carer in and around Staffordshire please call 0800 389 0143 or email [foster@nexusfostering.co.uk](mailto:foster@nexusfostering.co.uk)

### Covid Protocols

In light of the rises in positive covid cases across the Staffordshire Moorlands, we request that people continue to follow guidelines around social distancing, our one way system and face coverings to keep our whole school community safe.



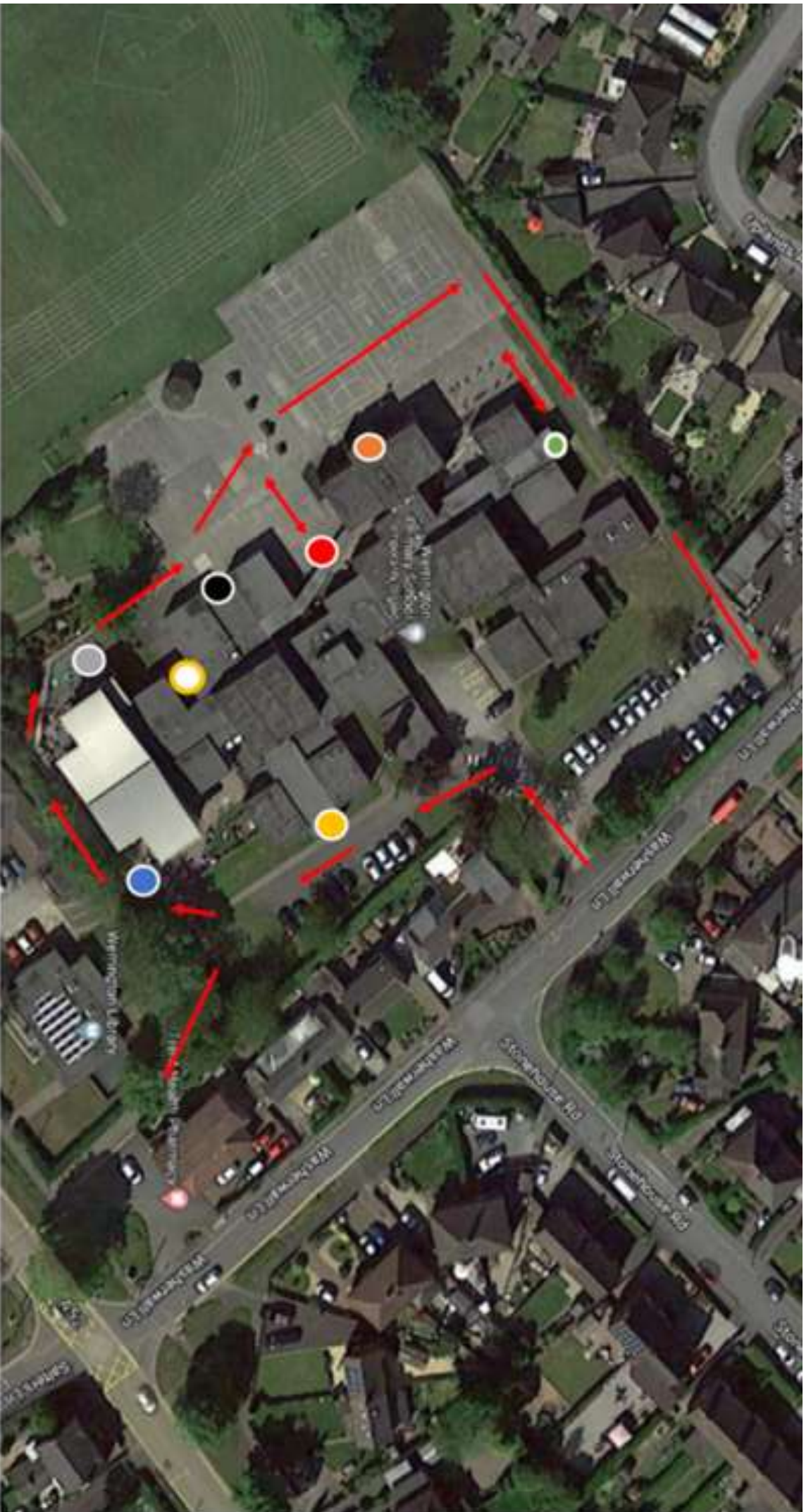

● Nursery and RMC entrance

● Year 2 entrance

● Year 5 entrance

● RLD entrance

● Year 3 entrance

● Year 6 entrance

● Year 1 Entrance

● Year 4 entrance

→ One way system